

SHAD

MOTO GUZZI V7 850 SPECIAL '23- TOP MASTER – M0V783T

BCN

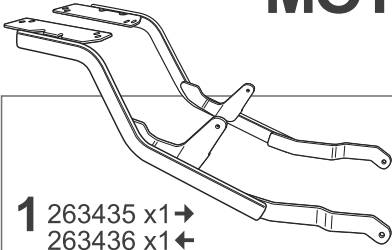

1 263435 x1 →
263436 x1 ←

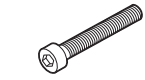

2 304037 x2
M6x35 DIN 912



3 304038 x2
M6x22 DIN 912



4 304039 x2
M8x40 DIN 7380



5 303045 x2
Ø8



6 303020 x2
Ø8



7 302024 x2
M8

WARNING! ⚠

(GB) Do not fully tighten the screws until it is ensured that the KIT is correctly attached and aligned. Check tightness every 4 months.

(E) No apretar los tornillos del todo hasta asegurarse que el KIT está correctamente colocado y alineado. Repasar apriete cada 4 meses.

(D) Ziehen Sie die Schrauben nicht ganz fest, bevor Sie sich nicht vergewissert haben, daß der Bausatz korrekt eingestellt und ausgerichtet ist. Alle 4 Monate Drehmoment überprüfen.

(I) Non stringere del tutto le viti fin tanto non si è sicuri che il kit è collocato correttamente e allineato. Controllare il serraggio delle viti ogni 4 mesi.

(F) Ne pas serrer les vis avant d'être sûr que le KIT soit correctement positionné et ajusté. Vérifier le serrage des vis tous les 4 mois.

ATTENTION: For a full equip assembly, mount the Top master before the 3P system.

V7 SPECIAL

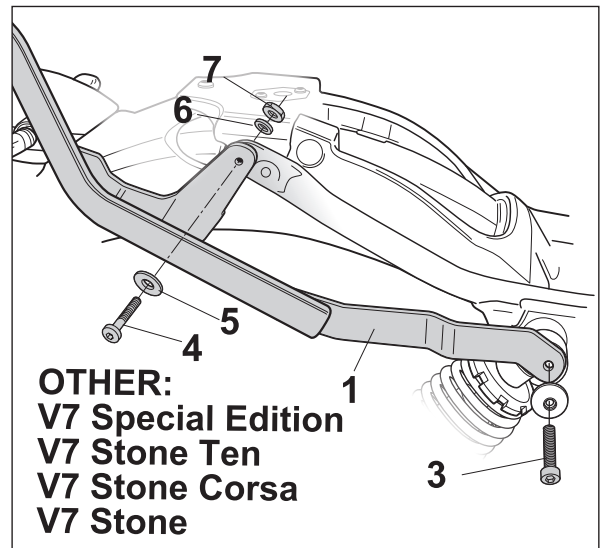
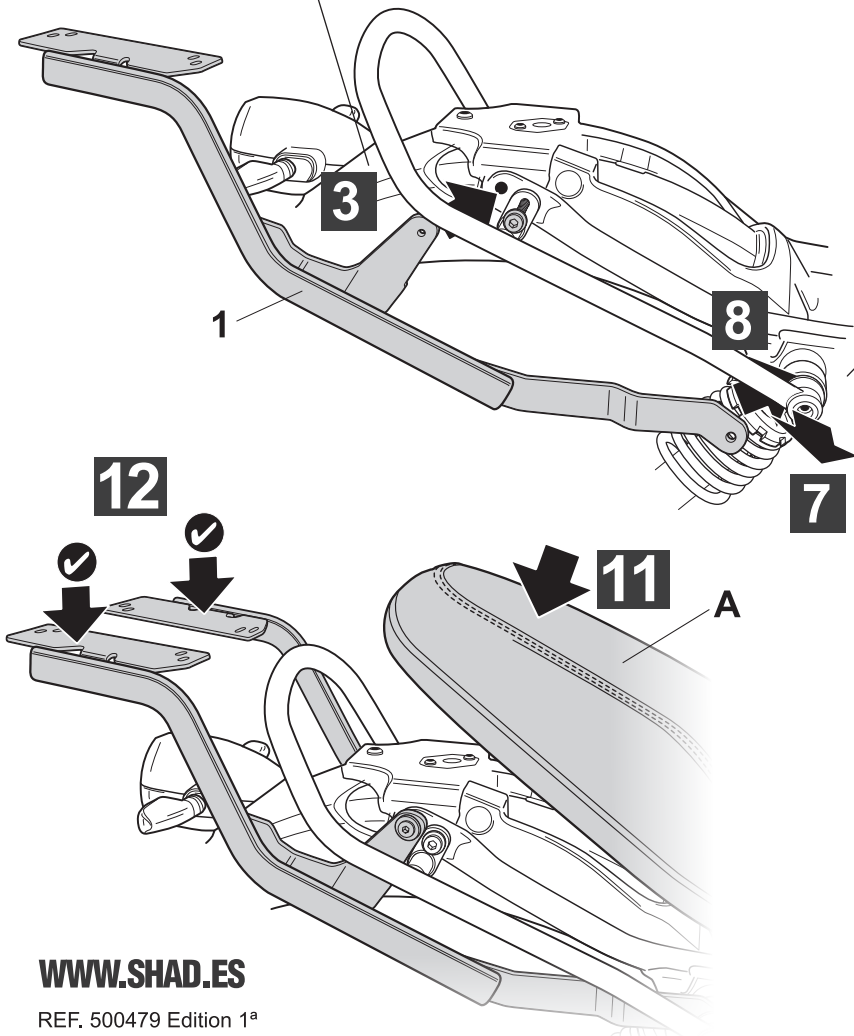
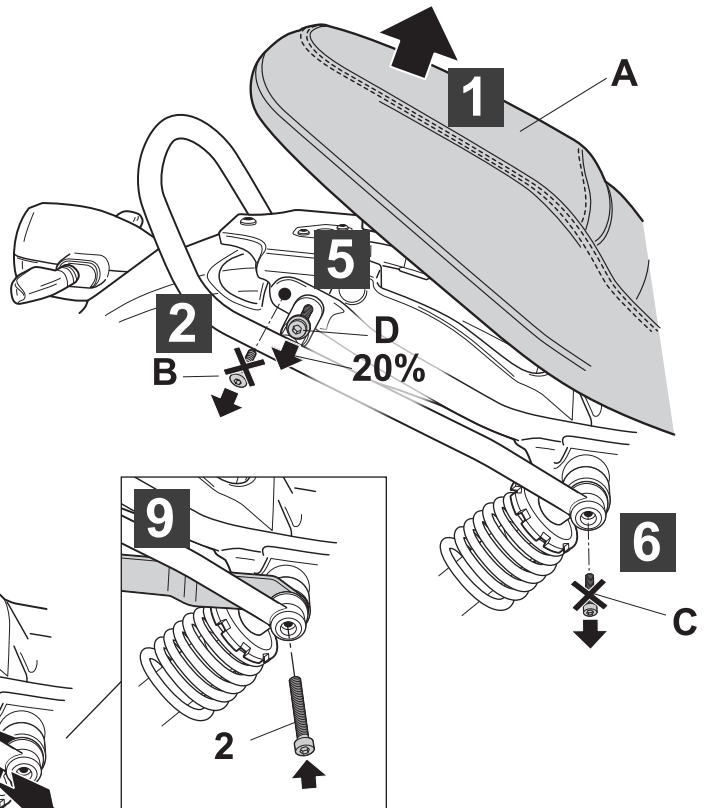
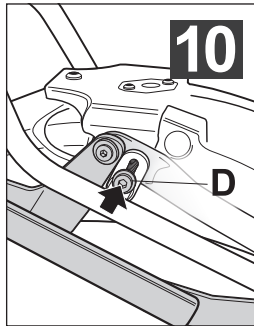
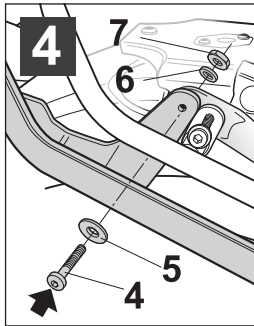

OTHER:
V7 Special Edition
V7 Stone Ten
V7 Stone Corsa
V7 Stone

WWW.SHAD.ES

REF. 500479 Edition 1ª

IMPORTANT: Based on European models. For compatibility with models in other continents, check www.shad.es